

Product Cut Sheet

AISLE CONTAINMENT DOOR TOP SEAL KIT

- Use with Cabinet Supported Aisle Containment Solutions only
- Seals the gap above the door when the door is attached to tall cabinets
- Use with all doors attached to the tops of cabinets that are over 88" (2235 mm) high
- Three size ranges; adjustable to match aisle width
- Flush mount and offset mount versions; use offset mount versions with the Door Standoff Kit (P/N 32870-XXX)

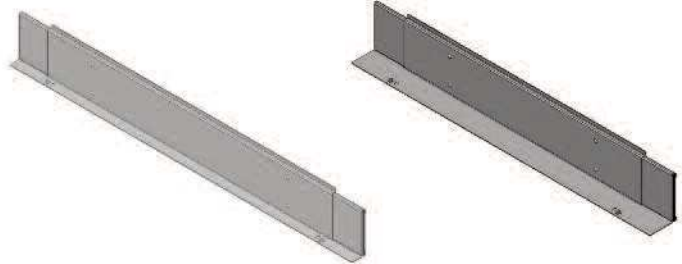

Door Top Seal Kit, Flush Mount,
For Use Without Standoff Kit

Door Top Seal Kit, Offset Mount,
For Use With Door Standoff Kit

| Door Top Seal Kit | | | |
|---|---------------|--|----------------------------|
| Part Number & Finish | | Description | Shipping Weight lb (kg) |
| Black | Glacier White | | |
| Flush Mount, For Use Without Door Standoff Kit | | | |
| 32817-701 | 32817-E01 | Adjusts 48"W (1200 mm) to 59"W (1500 mm) | 21 (9.5) |
| 32817-702 | 32817-E02 | Adjusts 59"W (1500 mm) to 70"W (1775 mm) | 24 (10.9) |
| 32817-703 | 32817-E03 | Adjusts 70"W (1775 mm) to 81"W (2050 mm) | 27 (12.3) |
| Offset Mount, For Use With Door Standoff Kit | | | |
| 32817-704 | 32817-E04 | Adjusts 48"W (1200 mm) to 59"W (1500 mm) | 24 (10.9) |
| 32817-705 | 32817-E05 | Adjusts 59"W (1500 mm) to 70"W (1775 mm) | 28 (12.7) |
| 32817-706 | 32817-E06 | Adjusts 70"W (1775 mm) to 81"W (2050 mm) | 31 (14.1) |

Note: Use when the tops of cabinets are over 88" (2235 mm) tall.

800-834-4969 in US & Canada • www.chatsworth.com



CHATSWORTH PRODUCTS, INC.

©2012 Chatsworth Products, Inc. All rights reserved. CPI, CPI Passive Cooling, MegaFrame, Saf-T-Grip, Seismic Frame, SlimFrame, TeraFrame, GlobalFrame, Cube-iT Plus, Evolution, OnTrac, QuadraRack and Velocity are federally registered trademarks of Chatsworth Products, Inc. eConnect and Simply Efficient are trademarks of Chatsworth Products, Inc. All other trademarks belong to their respective companies.